

# SLIDING GATE OPERATOR

# INSTRUCTION



**PLEASE READ THE MANUAL CAREFULLY  
BEFORE INSTALL AND USE**

## Preface

Dear users:

First of all thank you for choose the remote control door machine ! To make sure that you can fully familiar with the various functions of the unit, please read this manual carefully, so that you will be the unit of the structure, working principle, points for attention, such as the installation process fully understand the content, enables you to correct installation, safe use.

### security protection

- 1, Must use 240 v power supply voltage do not use the overpressure or under voltage;
- 2, The door installation or maintenance, please first cut off the input power supply;
- 3, Please make sure to open the door machine has reliable grounding, grounding resistance < 4 m, and have leakage short circuit protection
- 4, Orbit by an appropriate location, the door machine side should firmly welding a limit block iron, iron block should be beyond the limits of electrical limit place, can block on both sides to walk round the body not to take off From the roller constraints is advisable, in case of electrical limit failure when the gate from the constraints of the idler pulley on both sides cause tilting;
- 5, Before starting the door, should remove obstacles;The door is operation, it is strictly prohibited to vehicles, pedestrians walking;
- 6, The remote controller to avoid children to play, and the control box of switch;
- 7, Cannot disassembly motor by oneself, maintenance work should be conducted by professionals

### main technical parameters

- |  |   |
|--|---|
| 1, Supply power: AC240v/50HZ ;   | 2, Motor power:370W/550W/750W/1200W                 |
| 3, Starting current 3A   | 4, Motor speed : 1400r/min                          |
| 5, running speed: 12m/min  | 6, Suitable door weight :100-2000KG                 |
| 7, Temperature : -25°C~+70°C ;   | 8, Motor net weight : 12.2kg /12.8kg/14.5kg /16.2kg |
| 9, Reserved line installation : 1 square millimeter (or 1.5 square meter with two conductor) |   |

### Working principle and main structure and performance

This machine is consists of the motor, worm, gear, driven gear etc. The specific motor drives the worm, the worm transfers the motion to the worm gear and the driven gear(sprocket), and the driven gear drives the rack.

The motor transfers its motion energy to the sprocket through the worm and gear, the

driven gear. and the worm gear will both rotating when the clutch is engaged, so the door will to be open or close under electric control. When in power failure, get the clutch disengaged through the disengage key (turn 90°clockwise), this machine will to be affected manually to open or close the gate.

**Install the metal base**

Open the door machine should be installed with a bolt on the metal base. How to install metal base, as shown in (P 1)

(P1)

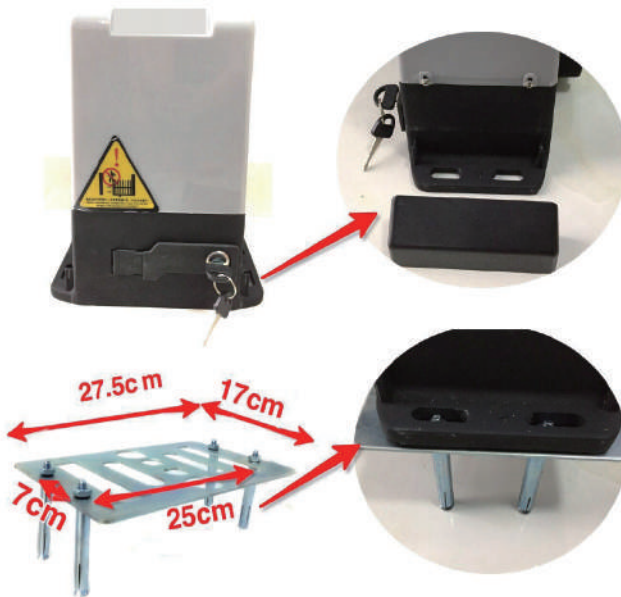

**Install the steel rack**

Installation steel rack and the simplest method is: first, put it above the door motor teeth, deviate from the door machine, and then through the door steel rack and push forward, bit by bit fixed the steel rack in the right place. Through this method, you can make sure the rack and pinion teeth bite together completely, in so doing, don't forget to mark each installation points. (P2) Remember not to press the weight of all the door on gear.

(P2)



### Door motor release clutch (manual open the door )

Door opener with the release of the lock device, to ensure that in the case of power fault , can be manually open the door, release and operation, such as (P3, )  
(P3)

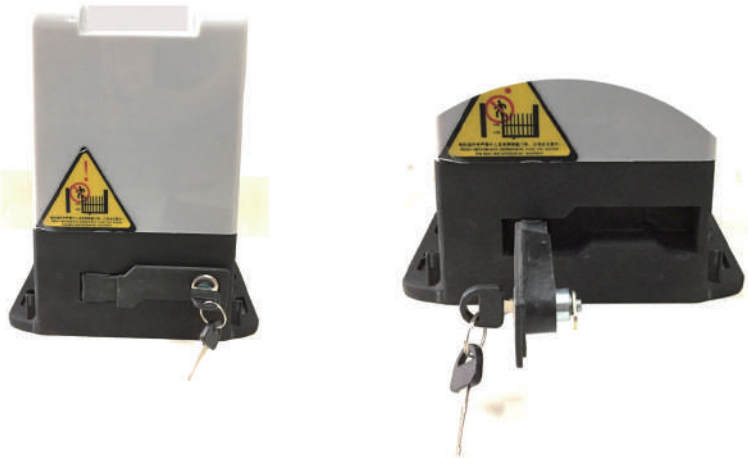

### Install the limit switch

According to the final position of stroke, to switch the bracket is installed on the rack (P4-P5). Spring switch limit, spring touch switch iron block is ok . Magnetic switch limit, magnet should point to the motor, and according to the position of shield shell magnetic limit switches to locate

Magnetic switch limit (P4)

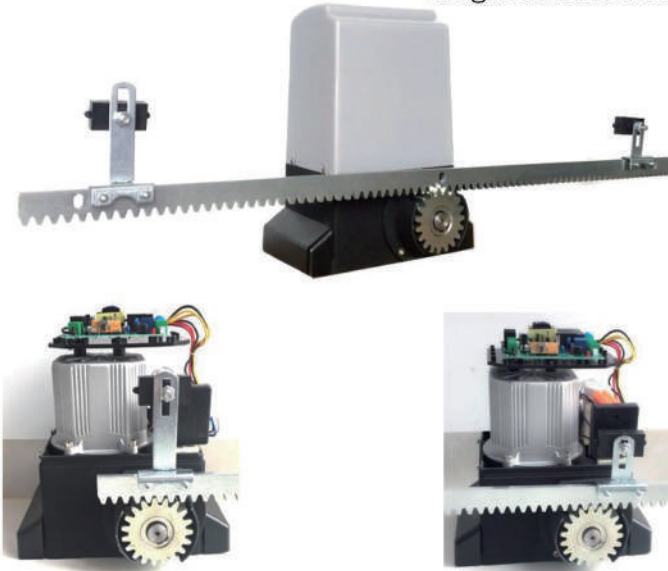

Spring switch limit (P5)



**Motor wiring diagram (P6)**

(P6)

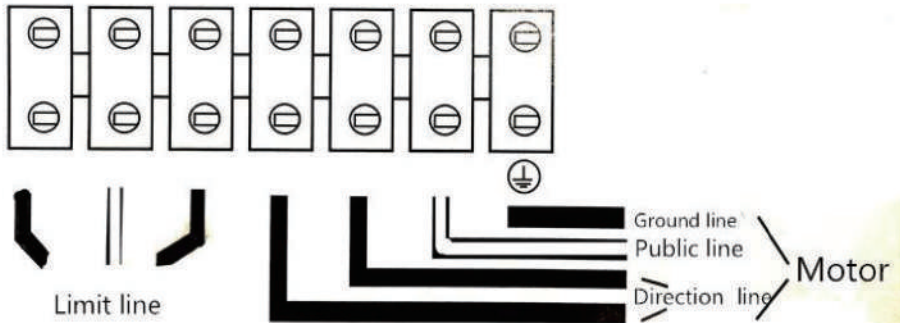
**Motor wiring diagram**

Controller connection, please read the controller specification

**Power supply test**

- 1, Before use, should carefully check the power supply voltage, frequency and other data is in accordance with the requirements, check whether the ground is a good, electrical wiring is correct.
- 2, With special random key counterclockwise, first open the clutch, push the sliding door, make the door machine idle, if open the door machine working normally, reoccupy special random on-off key clockwise, shut down the clutch.
- 3, Put through power supply, start to open the door machine, Observe the door machine running situation
- 4, Adjust the magnets or mechanical stop position, until the door open and closed position Comply with your Settings .

**Protection and maintenance**

- 1, The special clutch keyhole coated with a small amount of antirust oil, to prevent rust.
- 2, Regularly check the electrical grounding are in good condition;
- 3, Component are whether in good condition;
- 4, This motor adopts the advanced lubricating grease, do not need to replace or add lubricating oil.



**Possible obstacles and ruled out**

NO	Obstacles	Cause analysis	Clear and the method
1	Motor doesn't work	No power supply ,Capacitance to fail, overload, thermal protection device, inductive switch is damaged, whether the cable broken, loose, take off	Check the power supply, replace the capacitor, inspection door track whether there are obstacles, such as 20 minutes after the restart, replace the induction switch, the connecting cables connect well.
2	Can open (close), can't close (open)	Damage of induction switch, A/COM/C line is wrong, check the controller and motor	Replace the induction door, adjust the position, according to the wiring diagram properly connected, check whether the circuit is open circuit
3	Don't limit	Induction switch distance is too large, the induction switch position is not correct, the magnet or limit stop loss or position is not correct, W.V.COM is wrong, the induction switch is damaged.	Adjust the position, according to the wiring diagram properly connected, check whether the circuit is open circuit, replace the induction switch.
4	Manual clutch failure	The clutch handle is damaged, direction of rotation error, the clutch binding	Replace the clutch handle, according to the instructions direction, turn right or left output gear
5	Press "open"to "close"	Whether W.V line connection error	according to the wiring diagram properly connected
6	Motor rotation but not working	clutch pressure spring failure elasticity is insufficient, the clutch is disengaged, friction clutch pressure spring failure or loose.	Check, adjust or replace, correct match clutch, replace or adjust the spring pressure

## Sliding gate opener installation schematic diagram

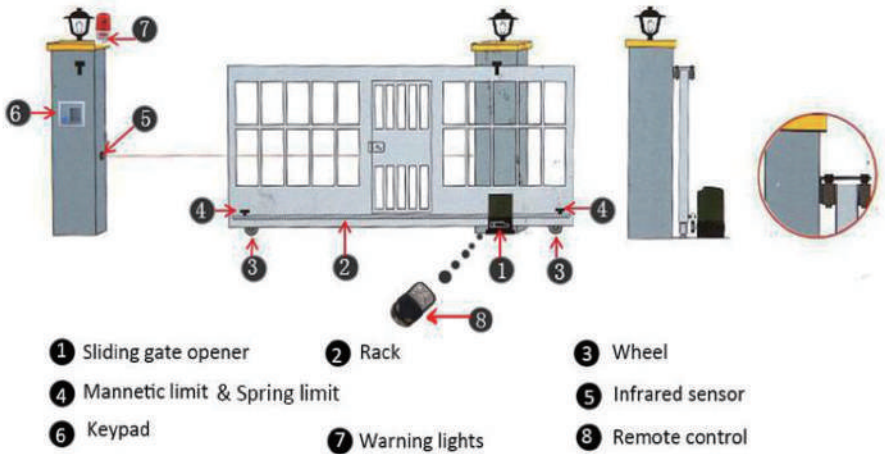

**CHANGZHOU WELD MACHINERY TECHNOLOGY.,LTD.**

**No.105,building 7, Linjin Garden, Yaoguan Town, Economic Development Zone, Changzhou City, China**

**Sibyl TEL: 86 1516 118 7689**

**EMAIL: sibyl@youngdl.com**